

FLANGE SO SS304L 300

Dimensiones en pulgadas y (milímetros)

Tamaño Nominal Tubería	Ø exterior O	Mínimo espesor tf	Ø Hub X	Longitud con Hub Y	Ø Mínimo agujero B	Ø Raised Face R	Taladros			Ø Tornillo
							Ø K centro tal.	No tal	Ø tal. L	
1/2 (DN15)	3.75 (95)	0.5 (12.7)	1.5 (38)	0.81 (21)	0.88 (22.2)	1.38 (34.9)	2.62 (66.7)	4	5/8 (15.875)	1/2 (12.7)
3/4 (DN20)	4.62 (115)	0.56 (14.3)	1.88 (48)	0.94 (24)	1.09 (27.7)	1.69 (42.9)	3.25 (82.6)	4	3/4 (19.05)	5/8 (15.875)
1 (DN25)	4.88 (125)	0.62 (15.9)	2.12 (54)	1 (25)	1.36 (34.5)	2 (50.8)	3.5 (88.9)	4	3/4 (19.05)	5/8 (15.875)
1 1/4 (DN32)	5.25 (135)	0.69 (17.5)	2.5 (64)	1 (25)	1.7 (43.2)	2.5 (63.5)	3.88 (98.4)	4	3/4 (19.05)	5/8 (15.875)
1 1/2 (DN40)	6.12 (155)	0.75 (19.1)	2.75 (70)	1.13 (29)	1.95 (49.5)	2.88 (73)	4.5 (114.3)	4	7/8 (22.225)	3/4 (19.05)
2 (DN50)	6.5 (165)	0.81 (20.7)	3.31 (84)	1.25 (32)	2.44 (61.9)	3.62 (92.1)	5 (127)	8	3/4 (19.05)	5/8 (15.875)
2 1/2 (DN65)	7.5 (190)	0.94 (23.9)	3.94 (100)	1.44 (37)	2.94 (74.6)	4.12 (104.8)	5.88 (149.2)	8	7/8 (22.225)	3/4 (19.05)
3 (DN80)	8.25 (210)	1.06 (27)	4.62 (117)	1.63 (41)	3.57 (90.7)	5 (127)	6.62 (168.3)	8	7/8 (22.225)	3/4 (19.05)
3 1/2 (DN90)	9 (230)	1.12 (28.6)	5.25 (133)	1.69 (43)	4.07 (103.4)	5.5 (139.7)	7.25 (184.2)	8	7/8 (22.225)	3/4 (19.05)
4 (DN100)	10 (255)	1.19 (30.2)	5.75 (146)	1.82 (46)	4.57 (116.1)	6.19 (157.2)	7.88 (200)	8	7/8 (22.225)	3/4 (19.05)
5 (DN125)	11 (280)	1.31 (33.4)	7 (178)	1.94 (49)	5.66 (143.8)	7.31 (185.7)	9.25 (235)	8	7/8 (22.225)	3/4 (19.05)
6 (DN150)	12.5 (320)	1.38 (35)	8.12 (206)	2 (51)	6.72 (170.7)	8.5 (215.9)	10.62 (269.9)	12	7/8 (22.225)	3/4 (19.05)
8 (DN200)	15 (380)	1.56 (39.7)	10.25 (260)	2.38 (60)	8.72 (221.5)	10.62 (269.9)	13 (330.2)	12	1 (25.4)	7/8 (22.225)
10 (DN250)	17.5 (445)	1.81 (46.1)	12.62 (321)	2.56 (65)	10.88 (276.2)	12.75 (323.8)	15.25 (387.4)	16	1 1/8 (28.575)	1 (25.4)
12 (DN300)	20.5 (520)	1.94 (49.3)	14.75 (375)	2.82 (71)	12.88 (327)	15 (381)	17.75 (450.8)	16	1 1/4 (31.75)	1 1/8 (28.575)
14 (DN350)	23 (585)	2.06 (52.4)	16.75 (425)	2.94 (75)	14.14 (359.2)	16.25 (412.8)	20.25 (514.4)	20	1 1/4 (31.75)	1 1/8 (28.575)
16 (DN400)	25.5 (650)	2.19 (55.6)	19 (483)	3.19 (81)	16.16 (410.5)	18.5 (469.9)	22.5 (571.5)	20	1 3/8 (34.925)	1 1/4 (31.75)
18 (DN450)	28 (710)	2.31 (58.8)	21 (533)	3.44 (87)	18.18 (461.8)	21 (533.4)	24.75 (628.6)	24	1 3/8 (34.925)	1 1/4 (31.75)
20 (DN500)	30.5 (775)	2.44 (62)	23.12 (587)	3.69 (94)	20.2 (513.1)	23 (584.2)	27 (685.8)	24	1 3/8 (34.925)	1 1/4 (31.75)
24 (DN600)	36 (915)	2.69 (68.3)	27.62 (702)	4.13 (105)	24.25 (616)	27.25 (692.2)	32 (812.8)	24	1 5/8 (41.275)	1 1/2 (38.1)

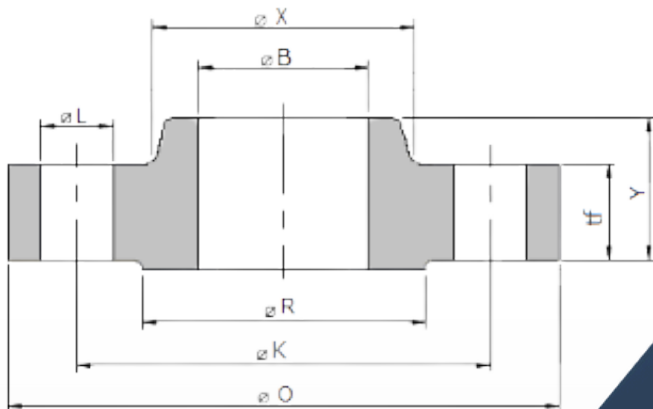

CONTÁCTANOS

 Lautaro 2083 2097
Lote 5, Concepción

 ventas@wenganindustrial.cl

 +56 9 8731 4484

 www.wenganindustrial.cl

SÍGUENOS EN
REDES SOCIALES



@wenganindustrialtda