

## RM recto macho

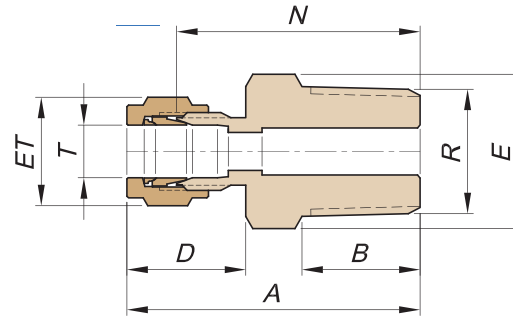

### Dimensiones para el montaje

| Modelo  | T<br>Tubo OD | R<br>NPT | DIMENSIONES ( MM ) |      |      |      |      |      |
|---------|--------------|----------|--------------------|------|------|------|------|------|
|         |              |          | A                  | B    | D    | E    | ET   | N    |
| RM 1-1- | 1/8          | 1/8      | 35.0               | 10.0 | 17.0 | 11.1 | 11.1 | 27.0 |
| RM 1-2- | 1/8          | 1/4      | 40.0               | 15.0 | 17.0 | 14.3 | 11.1 | 32.0 |
| RM 1-4- | 1/8          | 1/2      | 44.0               | 18.0 | 17.0 | 22.2 | 11.1 | 36.0 |
| RM 2-1- | 1/4          | 1/8      | 37.2               | 10.0 | 19.2 | 14.3 | 14.3 | 29.0 |
| RM 2-2- | 1/4          | 1/4      | 42.2               | 15.0 | 19.2 | 14.3 | 14.3 | 34.0 |
| RM 2-3- | 1/4          | 3/8      | 42.2               | 15.0 | 19.2 | 17.3 | 14.3 | 34.0 |
| RM 2-4- | 1/4          | 1/2      | 46.2               | 18.0 | 19.2 | 22.2 | 14.3 | 38.0 |
| RM 2-6- | 1/4          | 3/4      | 49.2               | 20.0 | 19.2 | 27.0 | 14.3 | 41.0 |
| RM 3-1- | 3/8          | 1/8      | 39.1               | 10.0 | 21.1 | 15.9 | 17.3 | 30.0 |
| RM 3-2- | 3/8          | 1/4      | 44.1               | 15.0 | 21.1 | 15.9 | 17.3 | 35.0 |
| RM 3-3- | 3/8          | 3/8      | 44.1               | 15.0 | 21.1 | 17.3 | 17.3 | 35.0 |
| RM 3-4- | 3/8          | 1/2      | 48.1               | 18.0 | 21.1 | 22.2 | 17.3 | 39.0 |
| RM 3-6- | 3/8          | 3/4      | 51.1               | 20.0 | 21.1 | 27.0 | 17.3 | 42.0 |
| RM 4-1- | 1/2          | 1/8      | 43.0               | 10.0 | 24.0 | 22.2 | 22.2 | 31.0 |
| RM 4-2- | 1/2          | 1/4      | 48.0               | 15.0 | 24.0 | 22.2 | 22.2 | 36.0 |
| RM 4-3- | 1/2          | 3/8      | 48.0               | 15.0 | 24.0 | 22.2 | 22.2 | 36.0 |
| RM 4-4- | 1/2          | 1/2      | 51.0               | 18.0 | 24.0 | 22.2 | 22.2 | 39.0 |
| RM 4-6- | 1/2          | 3/4      | 55.0               | 20.0 | 24.0 | 27.0 | 22.2 | 43.0 |
| RM 4-8- | 1/2          | 1        | 63.0               | 25.0 | 24.0 | 34.9 | 22.2 | 51.0 |
| RM 5-3- | 5/8          | 3/8      | 48.7               | 15.0 | 23.7 | 23.8 | 25.4 | 38.2 |
| RM 5-4- | 5/8          | 1/2      | 49.7               | 18.0 | 23.7 | 23.8 | 25.4 | 39.0 |
| RM 5-6- | 5/8          | 3/4      | 53.7               | 20.0 | 23.7 | 27.0 | 25.4 | 43.2 |
| RM 5-8- | 5/8          | 1        | 62.7               | 25.0 | 23.7 | 34.9 | 28.6 | 52.2 |
| RM 6-2- | 3/4          | 1/4      | 49.6               | 25.0 | 24.6 | 34.9 | 28.6 | 38.2 |
| RM 6-4- | 3/4          | 1/2      | 52.6               | 18.0 | 28.1 | 34.9 | 38.1 | 41.2 |
| RM 6-6- | 3/4          | 3/4      | 54.6               | 20.0 | 28.1 | 34.9 | 38.1 | 43.2 |
| RM 6-8- | 3/4          | 1        | 63.6               | 25.0 | 28.1 | 34.9 | 38.1 | 52.2 |
| RM 8-4- | 1            | 1/2      | 60.1               | 18.0 | 28.1 | 34.9 | 38.1 | 46.5 |
| RM 8-6- | 1            | 3/4      | 62.1               | 20.0 | 28.1 | 34.9 | 38.1 | 48.5 |
| RM 8-8- | 1            | 1        | 67.1               | 25.0 | 28.1 | 34.9 | 38.1 | 53.5 |

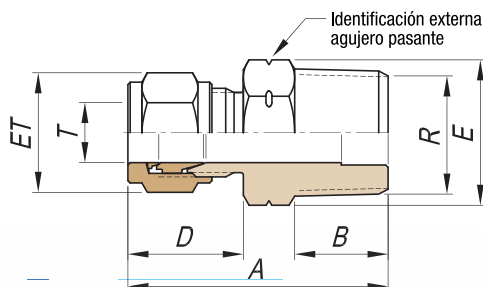

### Alternativa agujero pasante

Apto para montaje de termocuplas y tubos pescantes o de inmersión.

Agregue **AP** al código Ej: RM 2-2- 316-AP

## CONTÁCTANOS

Lautaro 2083 2097  
Lote 5, Concepción

ventas@wenganindustrial.cl

+56 9 8731 4484

www.wenganindustrial.cl

SÍGUENOS EN  
REDES SOCIALES

